

IPL T IRL

IP Link® IR Learner



FEATURES

- Captures IR remote control codes to create IP Link® IR drivers
- Front panel IR emitter verifies accuracy of captured IR codes
- Integral high performance Web server
- Free, easy-to-use IR learning software
- Supports industry standard Ethernet protocols
- UL/CUL listed and CE compliant
- External international power supply included, part # 70-055-01

DESCRIPTION

The Extron **IPL T IRL** is an IP Link® IR Learner that captures infrared remote control codes to create drivers usable with any IP Link® IR port. The IPL T IRL has the ability to learn IR codes from existing remote controls. It is designed to add devices to the comprehensive database of infrared codes supplied by Extron.

The IPL T IRL includes a front panel IR emitter that makes it easy to verify the accuracy of captured IR codes.

When used with the free Extron IR Learner software, you can "teach" commands to the IPL T IRL by transmitting infrared signals from your existing remote controls to the IPL T IRL's learning eye. To do this, simply point the device's remote control at the front panel of the IPL T IRL from a distance of between 2 and 12 feet.

Once the codes have been learned, they can be stored on a PC transmitted to any device with an IP Link IR port, such as the IPL T SFI244. Such a combination will allow any device that accepts IR control signals to be controlled from any computer connected to a Local Area Network, Wide Area Network, or the Internet.

SPECIFICATIONS

ETHERNET CONTROL INTERFACE

Connectors	1 RJ-45 female connector
Data rate	10/100Base-T, half/full duplex with autotdetect
Protocols	ARP, DHCP, ICMP (ping), TCP/IP, UDP/IP, Telnet, HTTP, SMTP
Default settings	Link speed and duplex level = autodetected IP address = 192.168.254.254 Subnet mask = 255.255.0.0 Gateway = 0.0.0.0 DHCP = off

SERIAL CONFIGURATION INTERFACE

Port number / Type	1 RS-232 serial
Connectors	(1) 9-pin female D
Baud rate and protocol	300 to 115200 baud default settings (adjustable), 9600 baud, 8 data bits, 1 stop bit, no parity
Pin configurations	2 = TX, 3 = RX, 5 = GND

IR / SERIAL CONTROL INTERFACE

Output number	1
Connectors	(1) 3.5 mm, 2 pole captive screw connector
IR output carrier frequency	30 kHz to 1 MHz
IR learning carrier frequency	30 kHz to 1 MHz
IR learning capture distance	2" (5.1 cm) to 12" (30.5 cm) from the front panel
Pin configurations	pin 1 = signal, pin 2 = GND

GENERAL

External power supply	100 VAC to 240 VAC, 50/60 Hz, external, autoswitchable; to 12 VDC, 1 A, regulated
Power input requirements	12 VDC, 0.5 A
Temperature / Humidity	Storage: -40 to +158 °F (-40 to +70 °C) / 10% to 90%, noncondensing Operating: +32 to +122 °F (0 to +50 °C) / 10% to 90%, noncondensing
Rack mount	Yes, with optional 1U 9.5" deep rack shelf kit, part #60-190-01; or the 1U 3.5" deep VersaTools® rack shelf kit, part #60-190-20 Also under-furniture mountable with optional bracket kit #70-212-01
Enclosure type	Metal
Enclosure dimensions	1.7" H x 4.3" W x 3.0" D (1U high, quarter rack wide) 4.3 cm H x 10.9 cm W x 7.6 cm D (Depth excludes connectors.)
Product / Shipping weight	0.7 lbs (0.3 kg) / 2 lbs (1 kg)
Vibration	ISTA 1A in carton (International Safe Transit Association)
Listings	UL, CUL (UL rated for use in a plenum air space; meets UL2043 and UL60950 for fire and smoke.)
Compliances	CE, FCC Class A, VCCI, AS/NZS, ICES
MTBF	30,000 hours
Warranty	3 years parts and labor

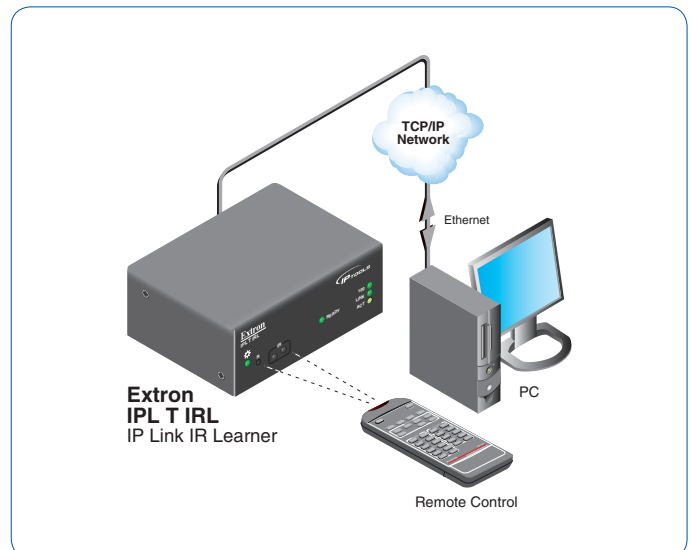

MODEL

IPL T IRL

VERSION DESCRIPTION

IR Learner

PART

60-544-08

USA
714.491.1500 / 800.633.9876
714.491.1517 FAX

Europe
+31.33.453.4040 / +800.3987.6673
+31.33.453.4050 FAX

Asia
+65.6383.4400 / +800.7339.8766
+65.6383.4664 FAX

Japan
+81.3.3511.7655
+81.3.3511.7656 FAX

www.extron.com
© 2006 Extron Electronics. All rights reserved.
Pricing and specifications may change without notice.